

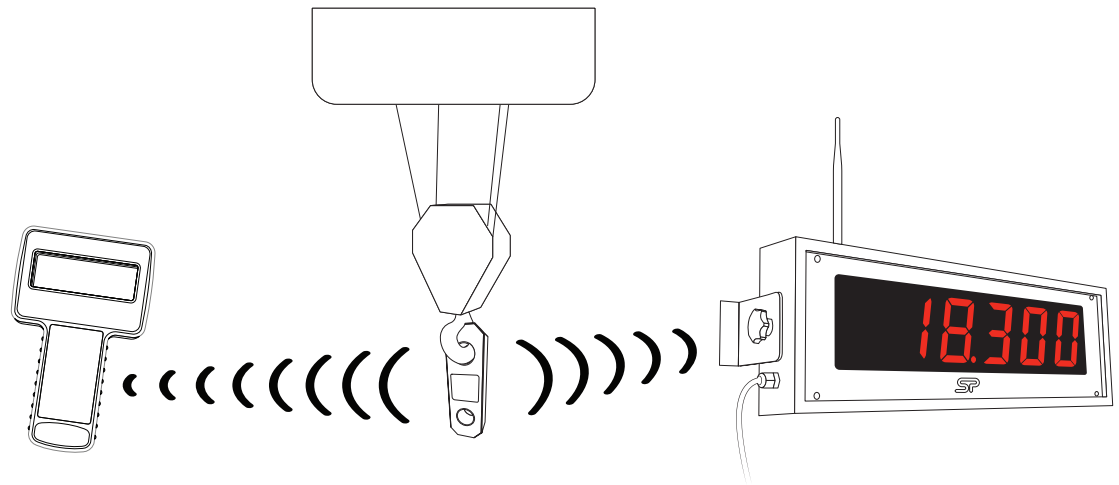

# SW-SD

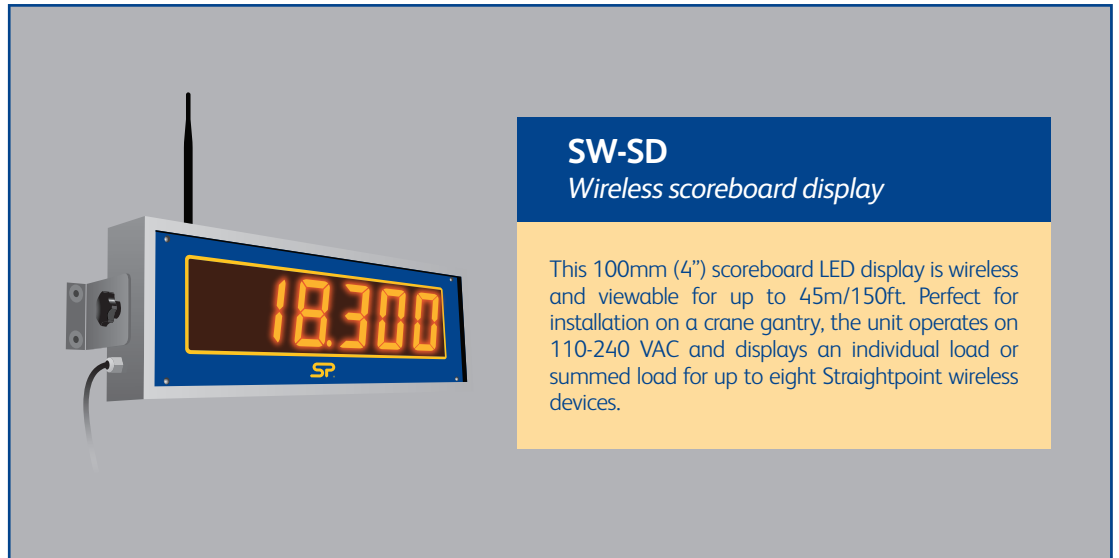

## Solution

### Features and benefits:

- Easy to read 100mm /4" LED display
- Rugged steel case
- Wall mount brackets supplied
- External antennae for maximum range
- Wide range for power supply input

Global Specifications Parameter	Minimum	Typical	Maximum	Units
External supply voltage range	110	240	250	Volts AC
Average operational current	-	1A	3.5A peak	mA
Operating temperature range	-20°C (-4°F)	-	65°C (149°F)	°C (°F)
Storage temperature range	-20°C (-4°F)	-	65°C (149°F)	°C (°F)
Range	700m / 2300ft			

